

Unit 6 13 Burton Place, Manchester, Lancashire, M15 4PT
Tel: 0161 637 8336
Email: contactus@ascendproperties.com
www.ascendproperties.com

Ascend

Built on higher standards



W3, Whitworth Street West, Manchester

£1,000 PCM

Right in the very heartbeat of Manchester city centre, this standout apartment sits within an exciting and seriously good looking development that puts you right where the action is, while still offering a calm and private retreat when you need it. Think front row seats to city life, with the option to retreat backstage whenever you fancy.

The apartment itself is seriously spacious and part of a small collection of modern buildings set against a backdrop of Manchester's iconic mill conversions. It is bold, stylish and built with quality in mind. Inside you will find wooden flooring throughout, a fully fitted German engineered kitchen that means business, and two sleek modern bathrooms. This is a place that does not cut corners and it shows.

Location wise, it does not get much better. Whitworth Street is moments away, Oxford Road train station is just a short walk, and Deansgate, Castlefield and Spinningfields are all right on your doorstep. Whether you are heading to work, meeting friends, or wandering home after dinner, everything you need is within easy reach.

To top it all off, the building also benefits from a concierge, because city living should always come with a little extra convenience.

This is a property that needs to be seen to be fully appreciated. If you would like to take a closer look or have any questions, get in touch and we will show you around.



GROUND FLOOR
467 sq.ft. (43.4 sq.m.) approx.

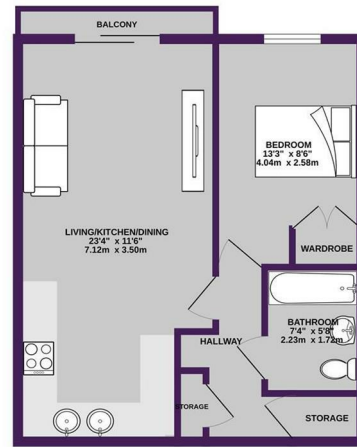

TOTAL FLOOR AREA - 467 sq.ft. (43.4 sq.m.) approx.
While every effort has been made to ensure the accuracy of the floor plan, the dimensions of the property are not guaranteed. The plan is for information only and should not be used for any purpose other than to provide a general impression of the property. The actual dimensions of the property may vary from those shown on the plan. The plan is not a contract and does not constitute an offer of any kind. The plan is for information only and should not be used for any purpose other than to provide a general impression of the property. The actual dimensions of the property may vary from those shown on the plan. The plan is not a contract and does not constitute an offer of any kind.

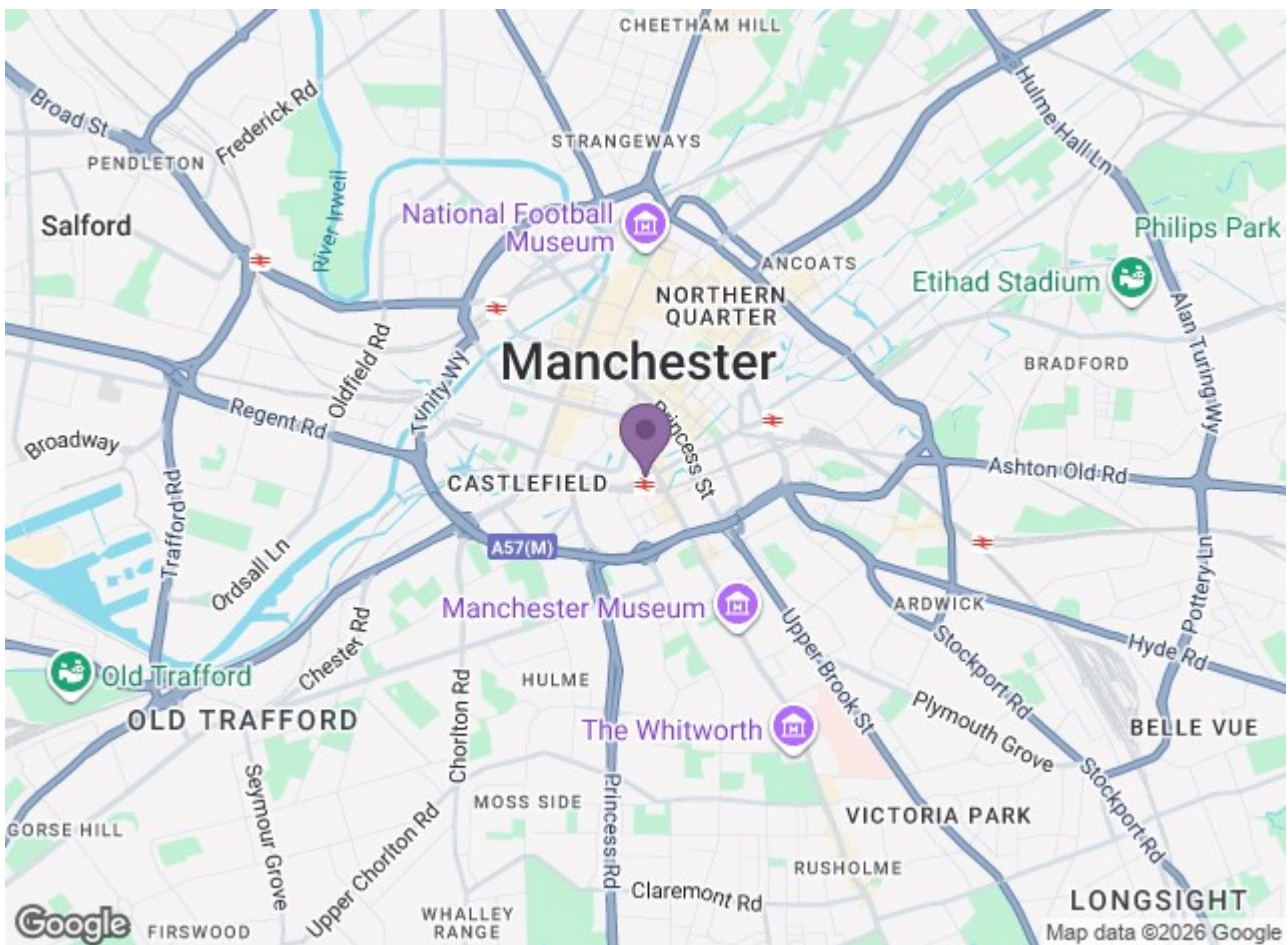

| Energy Efficiency Rating | | Environmental Impact (CO ₂) Rating | |
|--------------------------|-------|--|-------|
| Rating | Score | Rating | Score |
| A | 92 | A | 68 |
| B | 81 | B | 55 |
| C | 69 | C | 42 |
| D | 55 | D | 29 |
| E | 41 | E | 16 |
| F | 27 | F | 3 |
| G | 13 | G | -10 |

Ascend
Built on higher standards